



香港城市設計學會  
Hong Kong Institute of Urban Design

A vertical, colorful illustration of a multi-story building facade. The building is integrated with various mechanical elements like gears, pulleys, and cranes. People are shown engaged in different activities on different levels: some are working at desks, others are using a bicycle, and one is in a wheelchair. The background is a complex white line drawing of architectural and mechanical details.

# ACTIONS for ACTIVE AGEING

urban design for all  
HKIUD Conference 2018

22 June 2018 Friday

08:45–17:00

Owners Box, 3/F Members Stand I

Happy Valley Racecourse

Hong Kong Jockey Club

Conference Website





中國銀行(香港)

BANK OF CHINA (HONG KONG)

私人銀行

PRIVATE BANKING

Personal • Family • Business

## STABILITY IN MOTION

*Round Heaven over Square Earth* is the law of the universe originated from ancient Chinese philosophy. It states that all elements coexist and work in harmony for prosperity and sustainable development. With this timeless wisdom in mind, we at Bank of China (Hong Kong) are committed to helping you grow and preserve your wealth from our solid foundations. We offer a comprehensive portfolio of premier and tailored private banking services to bring your financial goals to fruition.

For more information on Bank of China (Hong Kong) Private Banking services, call us on +852 3982 6988 or email [privatebanking@bochk.com](mailto:privatebanking@bochk.com).



# Table of Contents

|   |    |
|---|----|
| Conference Programme .....  | 02 |
| Message from the HKIUD President .....  | 04 |
| Workshop and Survey Insights .....  | 05 |
| Speakers and Abstracts .....  | 10 |
| Moderators.....   | 21 |
| Panellists .....  | 23 |
| Closing Remarks from the HKIUD Conference 2018<br>Organizing Committee Chairman ..... | 26 |
| Acknowledgement.....  | 27 |
| Conference Organizing Committee Members .....   | 32 |

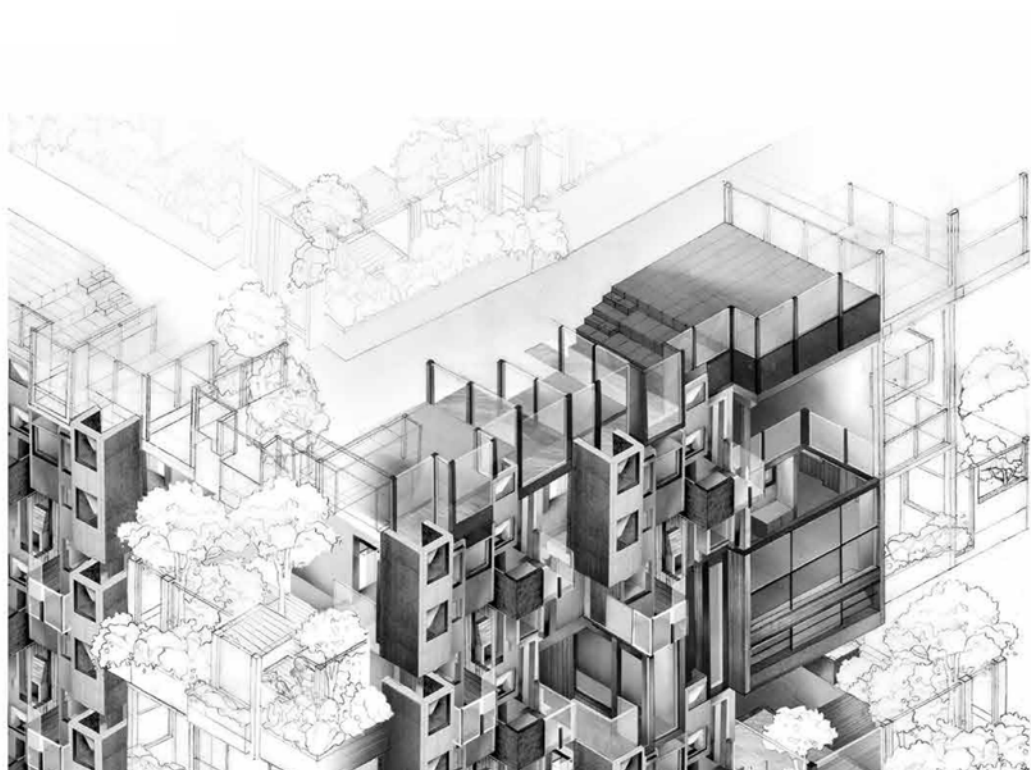

# Conference Programme

| Time          | Programme Item   |
|---------------|--|
| 08:45 – 09:25 | Morning Coffee   |
| 09:25 – 09:35 | <b>Opening Remarks</b><br><b>Prof. Stephen TANG, BBS, MHKIUD</b><br>President, The Hong Kong Institute of Urban Design   |
| 09:35 – 09:55 | <b>Hon. Bernard CHAN, GBS, JP</b><br>Convenor, Non-official Members of the Executive Council, HKSAR Government<br>Topic: Innovative Governance for Ageing  |
| 09:55 – 10:15 | <b>Mr Wilfred LAU, MHKIUD</b><br>Arup Fellow<br>Director, Arup<br>Topic: Adapting cities to ageing societies   |
| 10:15 – 10:30 | <b>Mr Leong CHEUNG</b><br>Executive Director, Charities & Community<br>The Hong Kong Jockey Club<br>Topic: Jockey Club's missions towards the Ageing Community   |
| 10:30 – 10:45 | Coffee Break   |
| 10:45 – 11:05 | <b>Prof. Hiroyuki MURATA</b><br>Professor, Smart Ageing Research Center, Tohoku University, Japan<br>Topic: Smart Ageing: concept and implementation – Pitfall of age-friendly design based on Japanese Experience   |
| 11:05 – 11:25 | <b>Ms Elaine TAN</b><br>Director, Architecture and Urban Design Excellence, Urban Redevelopment Authority Singapore<br>Topic: Designing for an Age-Enabled and Inclusive Community   |
| 11:25 – 11:45 | <b>Prof. Rebecca CHIU, MH, JP, ADHKIUD</b><br>Head, Department of Urban Planning and Design, Faculty of Architecture, The University of Hong Kong<br>Topic: Age-friendly housing in Hong Kong  |
| 11:45 – 12:25 | <b>Panel Discussion (Sponsored by The Hong Kong Jockey Club)</b><br>Moderator:<br><b>Mr Laurence LIAUW, MHKIUD</b><br>Director, SPADA and Spada Health Concepts<br><br>Panellists:<br>Mr Wilfred LAU, MHKIUD<br>Mr Leong CHEUNG<br>Prof. Hiroyuki MURATA<br>Ms Elaine TAN<br>Prof. Rebecca CHIU, MH, JP, ADHKIUD |

# Conference Programme

| Time          | Programme Item  |
|---------------|---|
| 12:25 – 13:40 | Lunch Break   |
| 13:40 – 13:55 | <b>Mr Joel CHAN, MHKIUD</b><br>Workshop Organizing Committee Chairman,<br>The Hong Kong Institute of Urban Design<br>Topic: Insight from the HKIUD Experiential Workshop on Active Ageing   |
| 13:55 – 14:15 | <b>Dr Hon. LAM Ching-choi, BBS, JP</b><br>Chairman, Hong Kong Elderly Commission, HKSAR Government<br>Topic: Inclusive urban design: built for health and mobility  |
| 14:15 – 14:35 | <b>Ms Marta POZO</b><br>Director, MVRDV Asia<br>Topic: All-In City. Designing cities to grow up and to grow old in  |
| 14:35 – 14:55 | <b>Mr Stefan KRUMMECK, MHKIUD</b><br>Director, Farrells<br>Topic: Walkability, Transport and Active Ageing  |
| 14:55 – 15:15 | <b>Prof. YU Yifan</b><br>Professor, Tongji University<br>Topic: The Impact of Urban Green Space on the Social Life of the Elderly: Empirical Research and Planning Response   |
| 15:15 – 15:35 | Coffee Break  |
| 15:35 – 16:35 | <b>Round Table (Sponsored by Bank of China (Hong Kong) Private Banking)</b><br>Moderator:<br><b>Mr Barry WILSON, MHKIUD</b><br>Founding Director, Barry Wilson Project Initiatives<br><br>Panellists:<br>Dr Hon. LAM Ching-choi, BBS, JP<br>Mr Wilfred LAU, MHKIUD<br>Mr Leong CHEUNG<br>Prof. Hiroyuki MURATA<br>Ms Elaine TAN<br>Mr Joel CHAN, MHKIUD<br>Ms Marta POZO<br>Mr Stefan KRUMMECK, MHKIUD<br>Prof. YU Yifan<br>Mr Marco WU, GBS, SBS<br>Ms. Winnie HO, JP, MHKIUD<br>Mr Timothy MA, JP |
| 16:35 – 16:40 | <b>Closing Remarks</b><br><b>Mr Charles LI, MHKIUD</b><br>Chairman, Organizing Committee of HKIUD Conference 2018   |

# Message from the HKIUD President



**Prof. Stephen TANG, BBS, MHKIUD**

Ageing population has emerged as an issue in most cities.

In Hong Kong, “Caring for the Elderly” and “Active Ageing” have recently risen to the forefront of our government’s policy agenda. As a representative of the city’s urban design industry, we at HKIUD see it as our mission to be informed and to inform others about how to improve our city’s liveability for the elderly from an urban design perspective.

Today, at the HKIUD Conference 2018, our goal is to differentiate what it takes to have a “liveable” urban environment, over and above a “survivable” one, for our elderly. A proper “liveable” urban environment ensures the external environment can contribute to better health and helps our elderly remain active. In doing so, the elderly can move around more freely, safely and independently. Let’s set a higher standard, for our elderly, a valuable part of our wider community.

Here in HKIUD, in our series of events – the Experiential Workshop held in March, the Survey conducted then, and also today’s Conference – we have invited leading stakeholders to collectively explore how our living environment can better the quality of life for our elderly. This is, however, not the end but instead the beginning of on-going efforts. We aim to translate discussion takeaways into a set of precise principles and guidelines that can be applied to actual projects.

Given the interdisciplinary nature of our work, there are angles to consider beyond architecture, land policy and development. We also consider healthcare, technology, equipment, transportation, welfare, and much more. To adequately tackle these issues, “Government-Industry-Academic-Research” collaboration is absolutely necessary.

I thank all our speakers for contributing their time and expertise, our sponsors for their generosity, everyone who has worked on these events for their effort, and all of you here today for joining us. Let’s work together for “Active Ageing”.

Thank you.



# Workshop and Survey Insights

# Workshop and Survey Insights

## Ageing in the Hong Kong Urban Environment – An Experiential Workshop

"Ageing in the Hong Kong Urban Environment – An Experiential Workshop" successfully held on 17 March 2018! As a major pre-conference event for the Hong Kong Institute of Urban Design (HKIUD) International Conference 2018 on the subject of "Actions for Active Ageing – Urban Design For All", the workshop was jointly organised by HKIUD, P&T Group and Hong Kong Sheng Kung Hui Welfare Council (SKHWC).

The workshop received support from approximately 40 invited participants, including Ms. Linn Hon Ho Bernadette, JP (Permanent Secretary for Development (Planning & Lands)), Hon. Tony Tse (Member of the Legislative Council for Architectural, Surveying, Planning and Landscape), Mrs. Sylvia Lam, JP (Director of Architectural Services Department), Mr. Raymond Lee, JP (Director of Planning Department), Ms. Alice Wan (Member of the Board of Directors, Southern District Healthy & Safe Association Limited) and Mrs. Susanne Wong, JP (District Officer of Central and Western).

In the morning section, participants geared up with the elderly simulation suit, which consists of several specially designed impediments such as weights, braces, elastic band restraints and a pair of blurry eyeglasses, which allow participants to feel how the aged bend their bodies and grasp the physical experiences of an elderly person. With the assistance of volunteers, participants were engaged in a number of typical outdoor daily life elderly activities in Western District, for example, visiting Western District Elderly Community Centre, trying out the community facilities and fitness equipment for the elderly in a park, and eventually experiencing different real-life hardships faced by the elderly.



(Picture 1 – 5 (Top Right) Hon. Bernard Chan, GBS, JP. (Top Left) Approximately 40 invited participants attended the workshop. (Lower Left) Mr. Alex Fong, (Lower Middle) and Ir. Wai Chi Sing, GBS, JP, geared up with the elderly simulation suits. (Lower Right) Ms. Linn Hon Ho Bernadette, JP (Permanent Secretary for Development (Planning & Lands)) geared up and said it was hard to walk briskly as usual, the escalator also appeared faster. She stated that elderly-friendly has become one of the planning principles of the government.

# Workshop and Survey Insights



(Picture 6) "I gained a better understanding of the stress experienced when the aged cross the road, I could not walk faster but the vehicles were already approaching." a participant said.



(Picture 7-10) (Upper left) Mr. Raymond Lee, JP (Director of Planning Department), (Upper right) Hon. Tony Tse (Member of the Legislative Council for Architectural, Surveying, Planning and Landscape), (Lower left & lower right) Mr. LEUNG Ka-wing (Former host of radio phone-in programme & head of Chinese programme service in RTHK's radio division) and Prof. Stephen Tang (President of The Hong Kong Institute of Urban Design) put on the Elderly Simulation Suit which enables users to experience what it feels like to have ageing induced limited mobility.



(Picture 11-12) (Left) Dr Jane Lee (Director of the Hong Kong Sheng Kung Hui Welfare Council) and Mrs. Susanne Wong, JP (The District Officer (Central and Western)) were concentrating on a sharing from a charitable non-profit organization, Hong Kong Public Space Initiative. Explanations were given on the importance of urban development for the elderly. (Right) Participants also visited Western District Elderly Community Centre, Mr. Robert Wong (Project Development Director, Hong Kong Sheng Kung Hui Welfare Council Limited) was sharing their elderly friendly projects.

# Workshop and Survey Insights

The professional forum was held in the afternoon and the speakers were all well-respected experts in their own fields. The presenters included: Mrs. Sylvia Lam (Director of Architectural Services Department), Ms. Alice Wan (Member of the Board of Directors, Southern District Healthy & Safe Association Limited), Mr. Robert Wong (Project Development Director, Hong Kong Sheng Kung Hui Welfare Council Limited) and Ms. Vivien Mak (Director of P&T). Attending organizations included Transport Department, Planning Department, Architectural Services Department, Leisure and Cultural Services Department, Hong Kong Housing Society, Urban Renewal Authority, Hong Kong Sheng Kung Hui Welfare Council Limited, MTR Corp. Limited, The University of Hong Kong, DUPAD, The Chinese University of Hong Kong & The Hong Kong Polytechnic University etc., focused on how urban design in Hong Kong can be more inclusive and enable the elderly to stay active, independent and remain healthy longer which is the overall challenge of active ageing.

Solid and diverse experiences were gained in this event with in-depth discussions.



(Picture 13-14) (Left) Prof. Stephen Tang (President of The Hong Kong Institute of Urban Design) and (Right) Mr. Joel Chan (Workshop Organizing Committee Chair)



(Picture 15-18) (Upper left) Ms. Vivien Mak (Director of P&T GROUP), (Upper Right) Mrs. Sylvia Lam (Director of Architectural Services Department), (Lower left) Mr. Robert Wong (Project Development Director, Hong Kong Sheng Kung Hui Welfare Council Limited) and (Lower right) Ms. Alice Wan (Member of the Board of Directors, Southern District Healthy & Safe Association Limited) shared their points of view on urban design and elderly friendly issues.

# Workshop and Survey Insights



(Picture 19-22) At the professional forum held in the afternoon session, approximately 40 invited participants were reflecting on how our urban design can be more inclusive and enable the elderly to stay active and remain healthy.

# Speakers and Abstracts



## **Hon. Bernard CHAN, GBS, JP**

**Convenor, Non-official Members of the Executive Council, HKSAR Government**

Bernard Charnwut Chan is a deputy to the National People's Congress of China, a non-official member of Hong Kong's Executive Council (2004-09 and from 2012) and (from 2017) the Convenor of the Non-Official Members of the Executive Council. He is also a former member of Hong Kong's Legislative Council (1998-2008).

A graduate of Pomona College in California, he is the President of Asia Financial Holdings and Asia Insurance. He is Chairman of the Hong Kong – Thailand Business Council and an advisor to Bangkok Bank (China) Co. Ltd. He sits on the boards of several local and overseas companies in the financial services and manufacturing sectors. He also joined the governing board of the Alibaba Entrepreneurs Fund in Hong Kong.

Among his public service activities, he is Chairman of the Committee on Reduction of Salt and Sugar in Food, Chairman of the Steering Committee on Restored Landfill Revitalisation Funding Scheme, Chairman of The Jockey Club CPS Ltd. Advisory Committee, Chairperson of the Hong Kong Council of Social Service and a Board Member of the West Kowloon Cultural District Authority. Past positions include Chairman of the Council for Sustainable Development, Chairman of the Antiquities Advisory Board, Chairman of the Advisory Committee on Revitalisation of Historic Buildings, Chairman of the Standing Committee on Judicial Salaries and Condition of Service as well as Council Chair of Lingnan University.

He was appointed a Justice of the Peace in 2002, and a Commander (3rd Class) of the Most Noble Order of the Crown of Thailand in 2004. In 2006, he was awarded the Gold Bauhinia Star by the Hong Kong SAR Government. He has been conferred honorary degrees from Lingnan University, City University of Hong Kong and the Open University of Hong Kong.

## **Innovative Governance for Ageing**

The Hong Kong government is committed to tackling the long-term challenges of an ageing population. In her first policy address last year, chief executive Carrie Lam specifically mentioned the need to explore new options in care delivery and home and community care services.

The government is also determined to play a leading role in encouraging new ideas to enable active ageing in terms of lifelong learning and volunteerism, innovation and technology, building design and urban planning.

## Mr Wilfred LAU, MHKIUD

Arup Fellow  
Director, Arup



Wilfred Lau is Arup Fellow and a Director of Arup, the global planning and engineering consultant. He has led Arup's consulting activities across East Asia for 15 years. He is a board member of Arup East Asia Region Board and was Chief Executive of Arup Vietnam 2008 to 2017. He was Arup Global Transport Planning Leader from 2001 to 2016.

Mr Lau was the Chairman of the Association of Consulting Engineers of Hong Kong and has represented the consulting industry on committees and expert panels. He is a Fellow of Institution of Civil Engineers, UK; Fellow of Hong Kong Institution of Engineers; Fellow of Chartered Institute of Logistic and Transport Hong Kong; Registered Professional Engineer of Hong Kong and member of Hong Kong Institute of Urban Design.

In recent years, Mr Lau focuses on development of cities and new towns in Asia, advising governments on development and delivery of future generation of cities. He developed the smart green resilient philosophy and is author of the book "Smart Green Resilient".

### Adapting cities to ageing societies

In Europe, ageing is one of the greatest economic and social challenges that OECD countries are facing, representing a radical demographic shift comparable to the industrial revolution. Can European cities respond to this change and deliver appropriate solutions? "Shaping ageing cities" is an Arup research providing a comparative overview of the structure of 10 selected European cities in response to the growth of our elderly population. The research revealed a complexity of geographies, relations, and processes that each of these cities is experiencing. A deep dive, focusing on Milan illustrates the human scale and the lives of older people in urban contexts which is crucial in understanding the vulnerabilities and opportunities around old age of both societal and the physical environment.

East-Asia is ageing rapidly. While Western solutions rely heavily on its developed institutional and communal services, the context of Asian cities requires a different approach that is more suitable to its culture and its unique built environment. The unprecedented nature of the transition means that earlier experiences of the advanced economies can provide only limited guidance and East Asia will need to develop its own response to this demographic shift.

The comparatively higher density and less ground-based residential care-homes along with lower average income of the elderly and the rapid urban development are impacting the daily life of the elderly in East Asian cities. Against such a cultural and contextual background, Arup is currently conducting another research that aims to develop a framework of approaches to adapt the East Asian built environment to an ageing society. The ideas presented in this research will focus on the aspects related to the built environment, such as mobility, living environment, and social life of elderly living in East Asian Cities.

This talk will provide insight of the European research and will also provide some initial findings of the current research of four East Asian cities.

# Speakers and Abstracts



## **Mr Leong CHEUNG**

**Executive Director, Charities & Community  
The Hong Kong Jockey Club**

Mr. Leong Cheung has been the Executive Director of Charities & Community at The Hong Kong Jockey Club since 2014. In this capacity he is also the co-Chair of the Hong Kong Chapter of the United Nations' Sustainable Development Solutions Network. In the financial year 2016-2017, The Hong Kong Jockey Club

donated HK\$7.6 billion to the community through the Club's Charities Trust for the betterment of our society.

Mr. Cheung has had extensive experience before joining the Club. He was an Operating Partner with Bain Capital. Prior to that, he was Managing Director of Global Sourcing & Supply Chain at Esquel Group, the founder and CEO of an education focused Internet venture, and a senior consultant at the Boston Consulting Group. Mr. Cheung is also co-Founder & Chairman of an innovative social enterprise, RunOurCity.

Mr. Cheung is active in the community. He currently serves in the Elderly Commission, and the Community Care Fund task force under the Commission on Poverty of the Hong Kong Special Administrative Region Government. He is a director of the Hong Kong Mortgage Corporation Limited and is an adjunct professor at the Chinese University of Hong Kong.

Mr. Cheung has an MBA from Harvard Business School and a BBA from the Chinese University of Hong Kong.

## **A Collaborative Approach to Build a City for All Ages in Hong Kong**

According to the Government's projection, almost one third of the Hong Kong population will be aged 65 or above in 2040. In response to that, the Hong Kong Jockey Club Charities Trust ("The Trust") has taken a proactive role in addressing both opportunities and challenges of an ageing population, and stipulated "Elderly" as one of the overarching strategic themes, aiming to build Hong Kong into an age-friendly city.

In 2015, the Trust partnered with Hong Kong's four gerontology research institutes to implement the Jockey Club Age-friendly City Project ("The Project") to build momentum for developing an age-friendly community. Using the WHO framework, the Project adopts a bottom-up, district-based approach to plant an age-friendly culture in all 18 districts in Hong Kong. So far, 12 districts have successfully joined the WHO Global Network of Age-friendly Cities and Communities. The remaining 6 districts are in process of applying for the recognition.

Under the Project, the four research institutes had conducted baseline assessment referencing the WHO standard for all 18 districts. The studies assessed the age-friendliness in key elements of urban environment and identify appropriate actions to support active and healthy ageing. More than 9,500 respondents and 91 focus groups with over 700 members have taken part in the study, of whom about 87% were 50 years old or above. The Project has also trained close to 1,000 ambassadors, engaged 53 NGO to organize 70+ district programs touching ~70K people. All 18 districts have set up regular committee within the District Council framework to continue promote Age-Friendliness in the districts.

This presentation will introduce the Trust's strategy and collaborative approach engaging multiple stakeholders to build our city, Hong Kong, for all ages.

## **Prof. Hiroyuki MURATA**

**Professor, Smart Ageing Research Center,  
Tohoku University, Japan**



Professor Hiro Murata is the most pioneer of active ageing business in Japan and an internationally recognized thought leader on ageing societies. He has worked with over 900 companies and contributed to develop various innovative products and services such as Curves Japan, the world's largest fitness chain for women in Japan, Raku-Raku phone, the best-selling age-friendly mobile phone, and various leading-edge retirement housings.

He is an entrepreneur, business producer, gerontologist, and best-selling author of several books, including *Senior Shift Impact: how to change the super ageing societies into business*, one of his best-selling books has been published in Chinese and Korean. *The Successful Business of Ageing: turning the super-aged society into business opportunities*, his most recent book is also published in Chinese. He serves as committee members for Cabinet Office, Ministry of Economy, Trade, and Industry, etc.

He is a frequent commentator to many leading media, including BBC, Wall Street Journal, Nikkei, Yomiuri, Asahi, Mainichi, Japan Industry News, Newsweek Japan, Financial Times, International Herald Tribune, New York Times, Dow Jones, Silver Industry News, TBS, NTV, Fuji TV, TV Tokyo, and NHK.

### **Smart Ageing: concept and implementation – Pitfall of age-friendly design based on Japanese Experience**

In Japan, many age-friendly housings and communities have been built since April, 2000 when the Long-term Care Insurance Act was in effective.

However, many of them have harmful influence on the residents at such housings and communities from the physical and mental independence point of view due to the age-friendly design and operation.

Prof. Murata will explain the pitfall of age-friendly design and introduce the concept and examples of “ageing-friendly” design instead of “age-friendly” one based on Japanese Experience.

Prof. Murata will then talk the concept of Smart Ageing he created in 2007. The concept has been realized as Smart Ageing International Research Center at Tohoku University since October 1, 2009. The Center has been renamed and reorganized as Smart Ageing Research Center as of April 1, 2017.

One of the great achievements of the Center is to realize Learning Therapy, an innovative non-pharmaceutical method to improve dementia based on leading-edge brain science research. Prof. Murata will share the theory of the program and how the demented users can improve their cognitive function drastically.

Prof. Murata also share how non-demented users can improve their mental health and prevent from dementia. He will tell how human being can extend his ability in his later stage of the life by brain plasticity.

# Speakers and Abstracts



## **Ms Elaine TAN**

**Director, Architecture and Urban Design  
Excellence, Urban Redevelopment Authority  
Singapore**

Elaine Tan is Director of Architecture & Urban Design Excellence at the Urban Redevelopment Authority, working closely with the industry to advance the state of architecture and urban design in Singapore through new initiatives and programmes. Prior to this, Elaine was Director of Strategic Research at URA. She spearheaded URA's R&D efforts and directed key research programmes through Singapore's Land and Liveability National Innovation Challenge, under the auspices of the Research, Innovation and Enterprise Council, chaired by the Prime Minister. Elaine is also URA's champion for Ageing issues and has been invited to various conferences and forums to share URA's work in planning for an aged population.

Elaine also established the Lee Kuan Yew World City Prize in 2010, in tribute to Singapore's first Prime Minister, into a recognised global biennial award today, as well as the President's Design Award to honour the best of Singapore's architecture and design.

Elaine studied both Architecture and Urban Design at the National University of Singapore and holds both a Masters in Urban Design and a Masters in Public Administration from the Lee Kuan Yew School of Public Policy.

## **Designing for an Age-Enabled and Inclusive Community**

Over the next few decades, Singapore's society will undergo a profound change with a rapidly ageing population. The number of seniors over 65 years old will double to 900,000 by 2030 and we are now looking to other super-aged countries to study ways in which we can cope with the challenges. Fundamentally, we should see our seniors as an asset to society and a positive force when given the support they need to contribute to society. Our goal is to tailor our efforts to their differing needs and to help them stay healthy and active for as long as possible. For seniors who are more frail, our aim is to deliver the care that they need to live comfortable, dignified lives. The Action Plan for Successful Ageing, initiated by the Ministry of Health, is a collective and integrated effort to prepare our city and the presentation will share on some of the ongoing efforts and plans for the future.

**Prof. Rebecca CHIU, MH, JP, ADHKIUD**  
Head, Department of Urban Planning and Design,  
Faculty of Architecture, The University of Hong Kong



Rebecca L.H. Chiu is Head and Professor of the Department of Urban Planning and Design, and the Director of the Centre of Urban Studies and Urban Planning, and the Belt and Road Urban Observatory of the Faculty of Architecture of the University of Hong Kong. She has specialized in housing studies since 1987, and in housing and urban sustainability since 1997. Her current research interests include sustainable urban development and sustainable housing of high-density cities, housing in ageing communities, comparative housing policies in Asia, urban management in the Belt and Road region, and comparative planning systems. She is the Founder Chairman of the Asia Pacific Network for Housing Research, and has been appointed to government committees and boards related to housing, planning, urban renewal, natural and heritage conservation in Hong Kong.

**Age-friendly housing and neighbourhoods: opportunities and constraints in compact Hong Kong**

Hong Kong is renowned for its well managed high-density and high-rise built environment. With a rapidly ageing population, it is increasingly important to (re)develop an elderly friendly living environment. Based on the findings from territory-wide surveys and focus group meetings, this presentation discusses the opportunities and constraints that Hong Kong's compact environment offers to its elderly inhabitants. In particular, it looks into the influence of the neighbourhood environment on the mental and social wellbeing of residents living in large high-rise housing estates. It concludes that compactness needs to be acknowledged as a critical factor to enable the less mobile senior citizens to have easy access to community facilities and services, and easy communication and integration with their local communities. While purpose-design vertical retirement projects provide a continuum of care and enables ageing in place fulfilling the daily and social needs of the elderly, accessibility to neighbourhood facilities and services and hence the location of these housing projects are important. Thus, a compact living environment, if well planned, designed and managed, provides unique opportunities not only to meet the daily needs of the senior citizens, but also to sustain their psychological and mental health, enabling active and happy ageing.

# Speakers and Abstracts



## **Mr Joel CHAN, MHKIUD**

**Workshop Organizing Committee Chairman, The Hong Kong Institute of Urban Design**

Mr. Joel Chan is the Chairman of the HKIUD Active Ageing Workshop which was held in March 2018, currently the HKIUD Honorary Treasurer, Chairman of the HKIUD Accreditation Committee and Chairman of the HKIUD Membership & Education Committee.

Mr. Chan has been actively involved in practice affairs and has been invited to speak in a number of symposiums. He is also the Vice-Chairman of the Professional Green Building Council, Director of the Beam Society Limited, Deputy Chairman of the HKIA Planning & Urban Design Committee, Deputy Chairman of the HKIA Buildings and Lands Committee and immediate past Chairman of HKIA Environment and Sustainable Development Committee.

Mr. Chan is a practicing architect and an urban designer with over 25 years' experience. As a Director of P&T GROUP in the region, he heads the Sustainability, Quality and BIM divisions of P&T GROUP. His works have received a number of international and local design awards, promoting livability and environmentally conscious design through practices.

### **Insight from the HKIUD Experiential Workshop on Active Ageing**

In preparing HKIUD Conference, we targeted to create a unique conference experience. Apart from sharing knowledge and experience of local and international speakers, we wish to carry the conference with actions and outcome, and thus the idea of a pre-conference workshop was derived.

The Workshop was conducted in March 2018 with positive feedback from the media, government departments, institutions and the community. Participants of the Workshop included government officials, legislators, elderly service providers, developers, academics, community groups and professionals. The Workshop aims to gather the major local stakeholders on the subject of elderly design by analysing the challenges of our elderly and summarizing the ageing problems prevailing Hong Kong. The findings in this workshop were then summarized to the speakers of the conference for their reference.

In the morning session of the Workshop, participants put on a specially designed suit which allowed them to experience the authentic carrying of an 80-year old elderly. Participants were engaged in a number of typical outdoor daily life elderly activities in Western District, amidst the urban environment of an old district in Hong Kong.

In the afternoon session, a professional forum was held to explore the topic further. Various stakeholders were invited to speak and share their knowledge in their initiatives of handling ageing issues. Finally, participants provided their opinion in the form of a survey on how urban design in Hong Kong can be more inclusive and enable the elderly to stay active, independent and healthy. Valuable opinion gained helps form the basis of more in-depth discussion in the Conference.

## **Dr Hon. LAM Ching-choi, BBS, JP** Chairman, Hong Kong Elderly Commission, HKSAR Government



Dr. Lam is a specialist in paediatric medicine and is now the Chief Executive Officer of Haven of Hope Christian Service. Under his leadership, Haven of Hope Christian Service is one of the pioneers in the provision of holistic care for the elderly in Hong Kong.

He is a non-official member of the Executive Council of the Government of the Hong Kong Special Administrative Region. He is also the Chairman of the Elderly Commission and he heads the Elderly Commission Working Group on Ageing in Place and advises the Government on the related policies. He is also the Chairman of the Community Investment & Inclusion Fund Committee and the Advisory Committee of “The Opportunities for the Elderly Project” of Social Welfare Department.

Dr. Lam has been honored by the HKSAR Government with the Justice of Peace in 2003 and Bronze Bauhinia Star in 2008 for his devotion to public services.

### **Inclusive urban design: built for health and mobility**

There will be a significant increase in the size of elderly population. Using the definition adopted in HK 2030+, Hong Kong is currently no longer an “ageing society” but an “aged society”, and soon a “hyper-aged society”. To prepare for this transformation, seniors’ urban design is one of the key topics, and this presentation will focus on four goals and gaps in relations to senior housing and urban design.

One of the goals is the continuum of care under one roof at senior citizen residences which integrate purpose-built housing for elderly persons with comprehensive recreational, health and care facilities. Currently, there are three housing projects completed – two targeting middle class (Jolly place and Cheerful court), one targeting upper class (Tanner Hill). Entrance to the lower-end market should be explored.

Another goal is to enhance mutual community support, receive home care services, and attend elderly centers in the vicinity in the elderly community building cluster with assisted living services.

Besides, age-friendly estate development shall include age-friendly and barrier-free public area. A community may not be originally built for elders, but soon emerges as a home to a significant proportion of them due to ageing in place, in-migration of older residents, and out-migration of younger residents.

Universal design and home modification for general housing is significant too. Universal design concept is already implemented in new public rental housing. One of the gaps is limited access by the widest spectrum of people regardless of diversity, age and ability. Moreover, “universal design concept” is not compulsory for private property development.

By consolidating the concept of ageing in place, the government aim to enhance elderly autonomy, enable an active lifestyle for the ageing people, and improve quality of life of the elders.

# Speakers and Abstracts



**Ms Marta POZO**  
Director, MVRDV Asia

Marta Pozo is an architect, licensed BREEAM assessor and LEED green Associate. She has worked at MVRDV since 2007. In 2014 Marta was relocated to Shanghai to head the firm's Asian office to expand MVRDV profile in Asian market as well as to oversee Asian projects. In addition to her role as Director of MVRDV Asia, Marta leads the Sustainability department for MVRDV.

By establishing a comprehensive framework for sustainability and forming environmental strategies, she ensures an exceptionally high standard is maintained in all projects.

Marta received architecture and engineering degrees from Universidad Politécnica de Valencia in 2001 and TU Berlin in 2004. She regularly lectures internationally and has won several awards. She has also contributed to MVRDV publications on sustainability.

## All-In City. Designing cities to grow up and to grow old in

Since its foundation in 1993, MVRDV continues developing strategies to increase the density and capacity of the built environment. Our philosophy seeks to contribute to improving the livability of cities and to celebrate the diversity of its inhabitants.

The first housing building completed by MVRDV was a revolutionary elderly complex. It was an attempt to break through the stereotype of senior care homes by creating both an exciting and playful apartment building. It happens so often that with the necessity of providing efficient assisted living facilities, it is forgotten that it is also important, to combine care services with vibrant and joyful environments that can empower senior citizens.

In a step further, towards inclusiveness and diversity, MVRDV explored the idea of multi-generational living in Silodam building. Mixing generations and ensuring active programming are tools to create and sustain lively communities where ageing is a graceful and happy aspect of life.

What would happen if we take the ingredients of retirement houses, elderly neighbourhoods or multi-age environments and we disperse them in the city? And if we connect these ingredients with a network of accessible pocket parks and small scale commerce? How our city will look like if we scale up the lessons from nursing homes and intergenerational housing and we dissolve them in the urban context?

MVRDV investigated these questions in different urban planning projects. For Seoulo 7017 Skygarden, we created an accessible urban park to stimulate and encourage senior citizens to go out and socialise in a safe, welcoming and attractive environment. In Bastide Niel, France, we challenged the urban regulations by creating intimate streets that prioritised pedestrian over cars within small grain urban fabrics. The citizens of neighbouring streets who in large number are seniors, participated through workshops in the design process for the new district. Such process engages and integrates elderly citizens in the city making as meaningful part of a larger society. Market Hall, in Rotterdam, provides an optimistic alternative, and it introduces a human-scale model for a commercial food hall, where elderly people can go to get daily groceries in a contemporary and safe building.

During the lecture, MVRDV will present through its projects, a vision of an open, stimulating and optimistic city for all of us to live in. A city designed with the elderly in mind, is a city designed for all.

## Mr Stefan KRUMMECK, MHKIUD

Director, Farrells



Stefan Krummeck, Director of Farrells, is an architect and urban designer with more than 25 years of experience designing award-winning buildings and master plans that have shaped towns and cities throughout the world. As a long-time proponent of transit-oriented development, Stefan believes in the complementary relationship between walkability and public transport, and that vibrant, people-friendly streetscapes play an integral role in city sustainability and the success of urban master plans.

His firm's recent work includes Kennedy Town Station, noted for its people-oriented design, as well as the iconic Kennedy Town Swimming Pool. The upcoming M+ museum, located at the crux between a new park and a new urban plaza, will serve as a highly-recognisable beacon for the West Kowloon Cultural District, a new arts district being built under a Development Plan produced by Farrells.

### Walkability, Transport and Active Ageing

Hong Kong now boasts one of the longest average life expectancies on earth. Hong Kongers' longevity, coupled with declining birth rates, means that our population is ageing fast – with the number of Hong Kong seniors expected to double to 2.37 million within the next two decades.

As a high-intensity, high-energy city, Hong Kong is far from the sleepy rural idyll typically envisaged as the perfect retirement destination. Urban design plays an important role in contributing to quality of life for all ages, but urban conditions can have a much stronger bearing on seniors, who face greater challenges getting around, and who have particular needs regarding the design of public space and parks.

Our infrastructure-driven, engineering-led city is built largely to serve the economy and the needs of the labour force. However, Hong Kong's unique urban model also holds opportunities to improve quality of life for older people. A compact, mixed-use urban form can enhance walkability, thereby improving seniors' access to daily needs as well as opportunities for socialisation and personal growth. The high-quality public transport system can help seniors traverse the city. Access to green space, a product of Hong Kong's limited urban sprawl, can provide benefits to physical and mental health and wellbeing.

This talk will explore some questions relevant to urban designers working in Hong Kong and similar Asian cities, for instance: how does the scale and design of streetscapes and pedestrian networks impact walkability for seniors in particular? How can we ensure older people are empowered by, rather than alienated by, the public transport network? How do we address the needs of seniors within the scope of the massive infrastructure projects that often define modern city-making in Hong Kong and mainland China?

# Speakers and Abstracts



## **Prof. YU Yifan**

**Professor, Tongji University**

Dr. YUYifan, is a professor in Urban Planning at Tongji University. She obtained the Ph.D from Ecole des Hautes Etudes en Sciences Sociales, in Paris(France) in 2003, visited GSD at Harvard University(USA) as a senior research fellow during 2013-2014, served as an overseas research fellow at Paris Sorbonne University (France), as well as the expert in the Planning

Standardization committee of Ministry of the Housing and Urban-Rural Development, and vice President of Shanghai Urban Planning Association.

Focusing on housing, urban regeneration and healthy city, Prof. YU Yifan has published more than 60 articles, and authored three books. She won the honorary titles as Outstanding Scholar of Chinese Ministry of Education in 2007, Outstanding Scholar of Shanghai Science and Technology Commission in 2006, and Outstanding Woman in Shanghai in 2016. She founded and has led the Ageing City Lab in Tongji University since 2014.

The course “Urban Planning Principle” led by Professor YU Yifan won a honorary title of National award, and she is also a recipient of over 20 awards of the best practices of urban planning and design at national and local level.

### **The Impact of Urban Green Space on the Social Life of the Elderly: The empirical research and the planning response**

Urban Green Space (UGS) in the living environment is definitely significant in enhancing the quality of life (Kweon et al., 1998; Netuveli et al., 2006). It confers health benefits through providing suitable spaces for leisure activities and for meeting people. Lacking of UGS is ubiquitous in the high-density environment, such as in Hong Kong and Shanghai. This study examined the usage of UGS by aged people from the densely populated public housing neighborhoods in Shanghai. The research issues included a) the preference of visiting UGS within walking range, b) the major attributes of the UGS relevant to the social interaction, and c) the planning/design intervention to promote the social interaction.

ICT technology was applied to identify the green space often used by seniors. Through the behavioral spatial clustering analysis, we unexpectedly found that the street corner garden and the university campus greenery are highly efficiency compared to the community parks. A structured survey was followed in the targeted UGS to examine the association between social interaction and the built environment (N=486). The result reveals that the proximity is an important attribute, as well as socio-cultural environment, esthetics, relevant facilities, gardening maintenance and so on. The present study provokes us to rethink of the approaches to improve the social interaction of the elderly through UGS planning and design. Prof. YU Yifan will also share the efforts of the local government and the planners to promote the age-friendly city in Shanghai, at the turning point of the urban renewal era.

## Mr Laurence LIAUW, MHKIUD

Director, SPADA and Spada Health Concepts

Laurence Liauw is Director of SPADA and Spada Health Concepts. A Registered Architect in Hong Kong, he is also Adjunct Associate Professor in Urban Design at The University of Hong Kong's Faculty of Architecture, having taught at various universities since 2000. An ex-Investment Banker, he now has over 22 years of urban development consulting, masterplanning and architectural design experience working in the UK, South East Asia, Mainland China and Hong Kong. Professional work at Spada Health Concepts focuses on seniors' healthy lifestyle multigenerational communities including senior care living, and health & wellness theme developments in China and Asia. His SPADA consulting work also covers strategic planning and design of CBDs, TOD, airport cities, commercial, cultural and innovation districts. Laurence has won various design awards; his works have been exhibited at the 2006 Venice Architecture Biennale, 2009 Rotterdam Biennale, and 2010 Shanghai World Expo. He has published widely and lectured internationally.



# Moderators



## **Mr Barry WILSON, MHKIUD**

**Founding Director, Barry Wilson Project Initiatives**

Born in London, Barry Wilson is a multiskilled planning and design consultant, advocate, critic, lecturer and public speaker.

A qualified Landscape Architect and Urban Designer, he has 30 years' experience of worldwide design standards and construction management practices having lived and worked across 4 continents.

His cross-border practise has a longestablished base in Hong Kong specialising in sustainable urban design solutions and research themes applying 'future focused' thinking as a challenge to conventional approaches.

In 2012 he received award from the China International Urbanization Development Strategy Research Committee for his outstanding achievements and in 2016 presented his formative visions at TEDx in Guangzhou.

He sits on both the Council and the Public Affairs Committee of the Hong Kong Institute of Urban Design; regularly undertakes roles as part time professor at the University of Hong Kong; frequently publishes in the South China Morning Post; is Chairman of the Shenzhen Branch of the British Chamber of Commerce; and delightedly holds a private pilot licence.

## **Mr Marco WU, GBS, SBS** Chairman, Hong Kong Housing Society



Mr Marco Wu is the Chairman of the Hong Kong Housing Society. He is a past President of The Hong Kong Institute of Surveyors and The Hong Kong Institute of Real Estate Administrators, and was a member of the Long Term Housing Strategy Steering Committee. Mr Wu is a Fellow of The Hong Kong Institute of Surveyors and The Royal Institution of Chartered Surveyors, an Honorary Fellow of the Hong Kong Institute of Construction Managers, The Hong Kong Institute of Facility Management and The University of College of Estate Management, UK, and an Honorary Advisor of The Coalition of Professional Services Ltd.

Mr Wu had served the Government for 39 years. He was the Deputy Director of Housing from 1996 to 2003 and the Director of Buildings from 2003 to 2006. During his 26 years with the Housing Department, he made significant contribution to the formulation and review of major housing policies. As Director of Buildings, he was responsible for developing policies and strategies governing the control and facilitation of private building developments.

Mr Wu devoted himself to the work of the Hong Kong Housing Society after retiring from the civil service. He was the Vice-Chairman of the Housing Society from 2006 to 2012 and has been the Chairman since 2012. Mr Wu has been leading the Housing Society in fulfilling its mission of serving the people of Hong Kong in housing and related services, including providing subsidized housing for the needy, addressing housing and service needs of the elderly, redeveloping and rehabilitating aged rental estates to improve the living environment, and exploring new housing solutions for different income and age groups of the community.

Mr Wu was awarded Silver Bauhinia Star in 2006 and Gold Bauhinia Star in 2014 for his dedicated service to the community.

# Panellists



## **Ms. Winnie HO, JP, MHKIUD**

**Deputy Director of Architectural Services, HKSARG**

Ms. Winnie Ho joined the Hong Kong Government as an Architect in 1992. Since then her career has been closely associated with development of public buildings, infrastructure and urban planning of Hong Kong. She started with her first posting in the Architectural Services Department (ArchSD), designing and delivering public facilities including schools, health, leisure, culture and sports facilities, judiciary complex and government offices.

Ms. Ho was posted to the Development Bureau in 2010 and assumed the post as the Deputy Head of Energizing Kowloon East Office of the Development Bureau in Feb 2012. She took up the challenging policy initiative to transform Kowloon East from an old industrial area into an additional business district to support the long term economic development of Hong Kong.

## Mr Timothy MA, JP

Non-Executive Director, Urban Renewal Authority

Registered Social Worker, Fellow of Certified Risk Planner, Justice of Peace and Teaching Professor (ICRM).

Founding Executive Director and Board Member of Senior Citizen Home Safety Association, the biggest social enterprise in Hong Kong serving elderly and their families.

Former President of Association of Fundraising Professional (HK Chapter); Member of Inst. of Fundraising (London, UK); International Development Committee Member of AFP; Vice-President of General Chamber of Social Enterprise; Founding Member of Social Entrepreneur Forum; Co-opted Member of SIE Fund, HKSAR Govt., Member of Lottery Fund Advisory Committee, SWD & Technology Voucher & Program Fund Advisory Committee; Expert Member of the HKCAAVQ; Expert Network Member (Ageing) of World Economic Forum; Non-Executive Board Member of Urban Renewal Authority; Executive Council Member of Hong Kong Housing Society; Course Developer and Trainer of Fundraising for HK Council of Social Service Institute; Chief Consultant of Ma Kam Wah & Co. (Executive Management and Training Consultant); Project Consultant of Project Flame, The City Univ of Hong Kong; Visiting Lecturer of CUHK and HKU. Advisor of NPI (Shanghai) and SEI (Taiwan); Strategic Planner of Futien Social Organization Development HQs and Expert Trainer of Inst. of Community Interest, Shenzhen. And, Advisor of the Funder's Network for Ageing Well, Hong Kong.



# Closing Remarks from the HKIUD Conference 2018 Organizing Committee Chairman



**Mr Charles LI, MHKIUD**

On behalf of HKIUD, I would like to express my sincere gratitude to our world-class speakers, generous sponsors, and esteemed supporting organizations. This is the third international conference we have organized since 2012, and all your support has made this year's event the most meaningful one to date. We are truly honoured.

At HKIUD, we believe addressing the ageing population from an urban design perspective needs cooperation on both technical and policy levels, and from multiple disciplines. As professionals and policy makers, we must unite and consider the how urban design impacts upon Active Ageing.

A conference becomes a success only if participants arrive. They are the lifeblood of a conference. Thus, we do express our sincere thanks to all of you who has come today in person or via the internet. We hope the insights and views shared today will help all of us in facilitating a better built environment that benefits ourselves, our families, and our future generations.

This conference is never the end, but a beginning. We will consolidate and publish the findings from today's discussion and continue working closely with the government, -Industry-Academics-Research sectors in raising our urban design standards to accommodate our ageing population and benefit the wider public. We look forward to your joint efforts with us.

Last but not least, may I take this opportunity to thank our organizing committee members who have kindly taken up the important roles, and made my job never been easier.

Thank you.



# Acknowledgement

CREATING  
A **PRESENCE**  
FOR  
ABSENCE

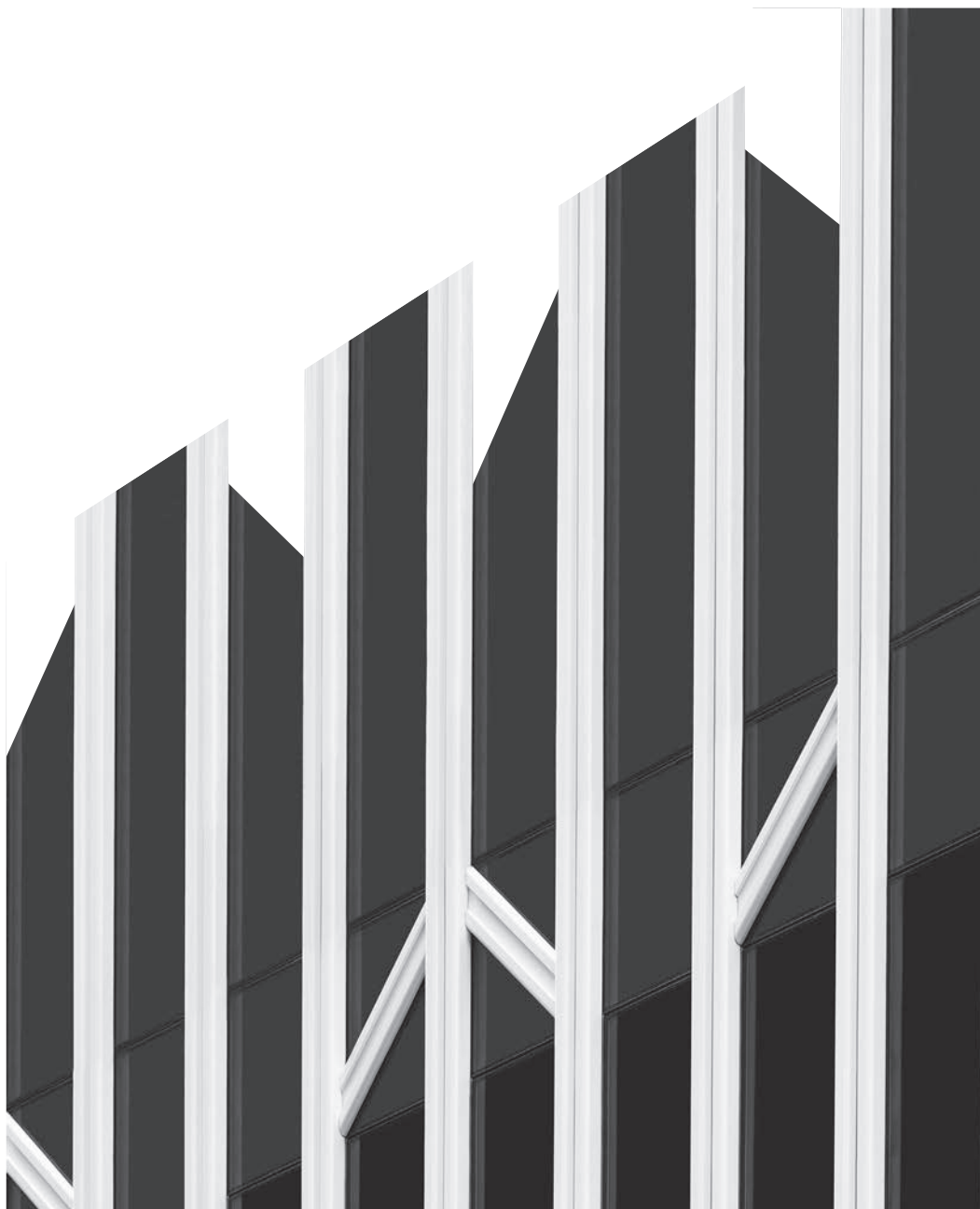

CHINACHEM CENTRAL – HONG KONG

[www.chinachemgroup.com](http://www.chinachemgroup.com)



華懋集團  
Chinachem Group

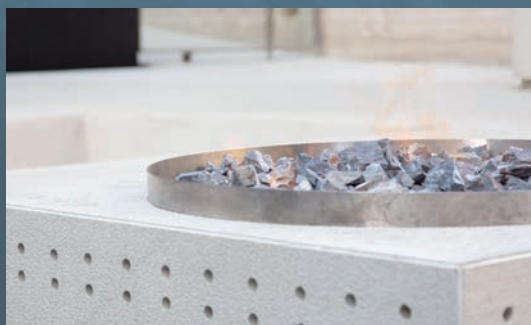
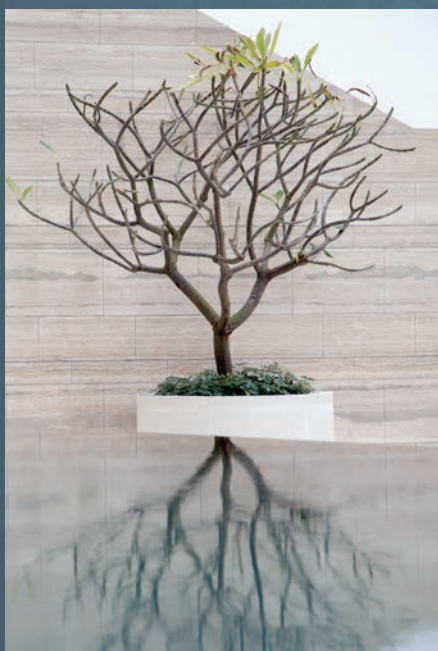

**The Artisanal Movement** is a cultural vision,  
a philosophy for living.

In the age of machines, we want to celebrate  
something more human and kindle  
the artisan spirit in us.

Through Collect, Connect, Collide,  
The Artisanal Movement becomes  
an incubator for ideas,  
and a channel for audiences  
to experience them.

*The Artisanal Movement*

WE CREATE, WE ARE ARTISANS



新世界發展有限公司  
New World Development Company Limited



80 QUEEN'S ROAD CENTRAL



HENDERSON LEASING AGENCY LIMITED

## THE CENTRE OF AN ARTFUL LIFESTYLE



Innovation,  
Creativity &  
Entrepreneurship  
三創投資

Quality • Value • Innovation • Service  
品質 • 價值 • 創新 • 服務

The Mills  
南豐紗廠

Hospitality  
酒店

Life Science  
生物科技

Property  
Development  
地產發展



# Sponsors and Supporting Organizations

## Silver Hair Star Sponsor



## Platinum Sponsor



## Gold Sponsors



## Silver Sponsors



## Bronze Sponsors



## Acknowledged by



## Supporting Organizations



## Media Partners



# Conference Organizing Committee Members

## Chairman

Mr. Charles LI, MHKIUD

## Vice Chairmen

Mr. Bernie HARRAD, MHKIUD

Mr. PY TAM, MHKIUD

## Members

Mr. Joel CHAN, MHKIUD

Prof. Alain CHIARADIA, MHKIUD

Ms. Sunnie LAU, MHKIUD

Mr. Chris LAW, MHKIUD

Mr. Laurence LIAUW, MHKIUD

Ms. Canny MA, MHKIUD

Prof. Stephen TANG, BBS, MHKIUD

Mr. Barry WILSON, MHKIUD

# 同心同步同進 共創更好未來

*RIDING HIGH TOGETHER  
FOR A BETTER FUTURE*



香港賽馬會是致力建設更美好社會的世界級賽馬機構，透過其結合賽馬及馬場娛樂、會員會所、有節制體育博彩及獎券，以及慈善及社區貢獻的綜合營運模式，創造經濟及社會價值，並協助政府打擊非法賭博。馬會是全港最大的單一納稅機構，在全球慈善捐助機構中，位列十大。

The Hong Kong Jockey Club is a world-class racing club that acts continuously for the betterment of our society. Through its integrated business model, comprising racing and racecourse entertainment, a membership club, responsible sports wagering and lottery, and charities and community contribution, the Club generates economic and social value for the community and supports the Government in combatting illegal gambling. It is Hong Kong's largest single taxpayer and one of the world's top ten charity donors.

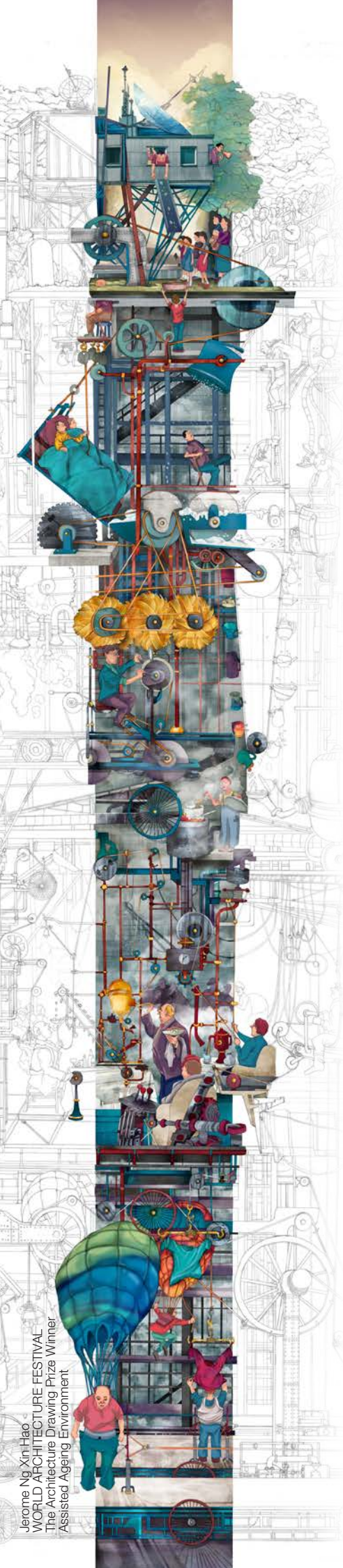

Jerome Ng Xin-Hao  
WORLD ARCHITECTURE FESTIVAL  
The Architecture Drawing Prize Winner  
Assisted Ageing Environment

e-survey



Live Q&A



香港城市設計學會  
Hong Kong Institute of Urban Design

香港金鐘金鐘道 89 號  
力寶中心第二座 5 樓 503 室  
Unit 503, 5/F, Tower Two Lippo Centre,  
89 Queensway, Admiralty, Hong Kong  
Tel: (852) 2235 9057  
Fax: (852) 3007 3607  
Web: [www.hkiud.org](http://www.hkiud.org)  
Email: [inq@hkiud.org](mailto:inq@hkiud.org)

